

# Instruction Manual

## SIGNAL TRANSDUCER (TACHOGENERATOR) Model 7544

I-01798

We thank you for your purchase of this product. Please take care that this instruction manual is certainly delivered to the person in charge of operating it. For safety use of this product, please observe the following caution and also read the instructions to follow before the initial operation for proper operation of this transducer.

### ⚠ CAUTION

- To prevent electric shock, observe the following cautions:**
- ◆ Never make power line connections with active lines.
  - ◆ Ensure firm and tight connections to the terminals.
  - ◆ Do not touch the power source terminals while the product is powered on.
- To avoid electric shock, failure or abnormal heat-up of the product, do not use it in such places where:**
- ◆ exposed to rain, water drops or direct sunlight.
  - ◆ high temperature or humidity, much dust or corrosive gas.
  - ◆ affected by external noise, radio waves or static electricity.
  - ◆ where there is constant vibration or shock.

### ● Check at Delivery

When the 7544 is delivered to you, please check that its specifications conform to your requirement and that there is no damage in transit. This transducer is carefully inspected before delivery from factory under our strict quality control program, but if you find any defect or inconvenience, please inform us of the model name, serial number etc. of the product.

### ● Cautions for Use

- ① This product is a precision instrument, so please take utmost care for its transportation, installation or any other handling of it.
- ② No power on-off switch is provided on this product, so it immediately starts to work when connected to the power source.
- ③ In case of fear that the noise or surge is frequently generated on the power source line, a noise preventive solution must be taken.
- ④ Use this product within the range of its specifications and rates.

### ● Product Outline

This product is the compact and insulated signal transducer which accepts as its input the AC voltage of tachometer dynamo and converts it to the desired DC voltage or DC current.

Thanks to its plug-in mount system, the installation can be done in an action on to the DIN rail, noticeably saving the time for installation work.

### ■ Installation

#### 1) Mounting

Mount the attached socket on to the DIN rail or fix it with M4 screws.

When two or more transducers are installed in series, keep a clearance in between the transducers as **Fig.1** shows.

#### 2) Location

Install the transducer in the place of ambient temperature  $-5\sim 55^{\circ}\text{C}$ , humidity 90%RH or less and no dew condensation.

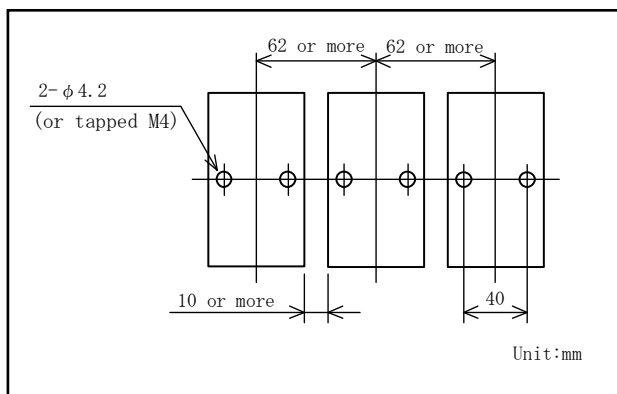

Fig.1

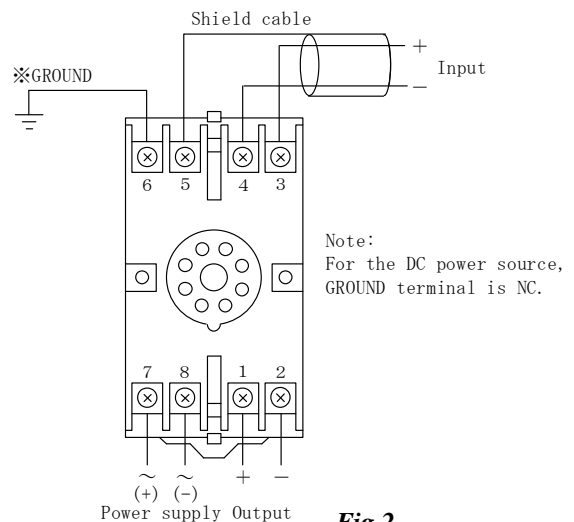

Fig.2

3) Connection

1. Terminal screws of this distributor are M3.5. Make firm and correct connection by using crimp type terminal etc.
2. Make the connection as per the connection diagram *Fig.2*, using the cables to meet the rated capacity of the circuit.
3. Before powering on the distributor, confirm that the rated value of input, output and power supply voltage, and cable connection are proper.

■Adjustment

The distributor is adjusted within its tolerable error at delivery from our factory. In case that a calibration is required, make an adjustment with ZERO and SPAN volumes provided on the front. Adjustable range is approximately  $\pm 5\%$  for ZERO and  $\pm 20\%$  for SPAN.

The calibration is recommended to be done in the ambient condition of  $23^{\circ}\text{C} \pm 2^{\circ}\text{C}$ , humidity 75%RH or less.

■Block diagram

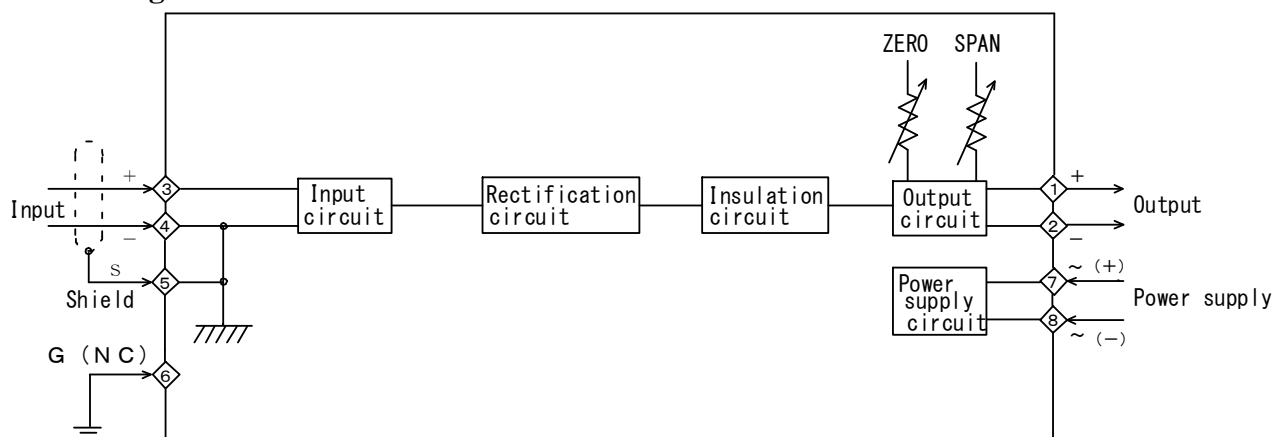

( ) are for the DC power supply.

■External dimensions

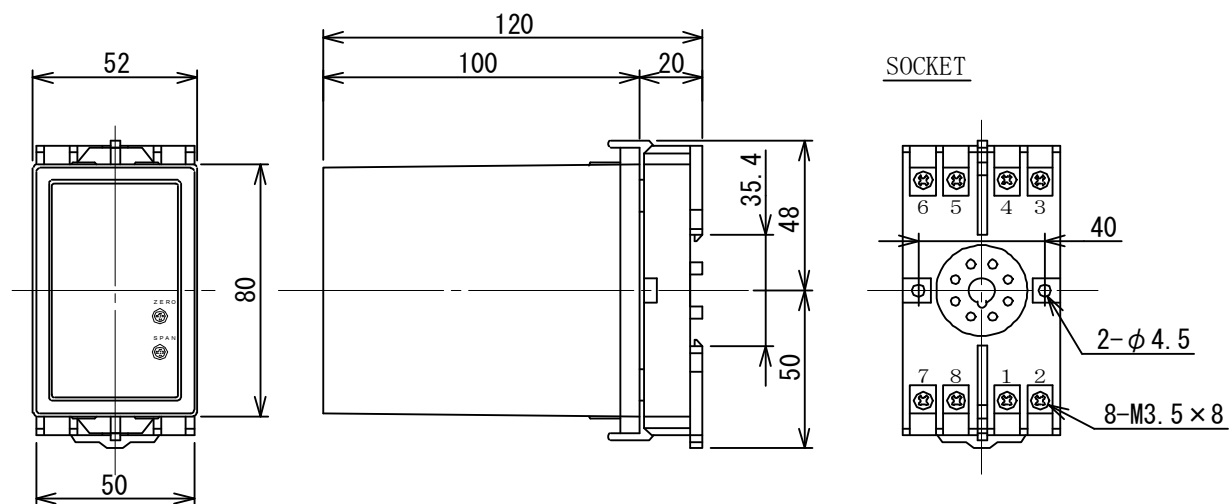

Unit: mm

Contact Information	
Name	: Tsuruga Electric Corporation
Address	: 1-3-23 Minami-Sumiyoshi, Sumiyoshi-ku, Osaka-shi 558-0041 Japan